

Product name

FZ0070055 V.211129.01

Sophie Desk

21-0318

USER MANUAL

Thank you for choosing our product. We hope you will find the instructions on this user manual clear and easy to follow. If you take a few minutes to look through it, you'll learn how to assemble and use of your new unit for maximum enjoyment.

This User Manual will provide basic instructions and safety guide for this products. After you have finished reading the instructions, please keep this manual in a safe place for future reference.

Should you ever experience a problem with of any our products, please fell free to contact us.



SAFETY INSTRUCTION

FAILURE TO COMPLY WITH OR OBSERVE ALL ASSEMBLY, SAFETY AND OPERATING INSTRUCTION AND WARNING REGARDING THE USE OF THIS PRODUCT MAY RESULT IN SERIOUS INJURY.

The safety of our clients and users is our primary concern. To ensure safe operation, please read this instruction carefully.

WARNING: Any furniture that is not anchored to a wall has the potential to tip over in certain circumstances, i.e. if a child attempts to climb up on the furniture or in the event of an earthquake. Accordingly, we strongly recommend securing all furniture to a wall using the anti-topple wall bracket supplied.

We have provided the fittings for attaching the wall bracket to the unit, but due to the different types of walls you might have, we not provided the fitting for attaching the bracket to your wall. You should first identify the type of wall you intent to fix the product to and then contact your local hardware store to get the appropriate fixings.

When attaching to walls always consider the position of any electrical cables or water pipes nearby.

WARNING

FAILURE TO FOLLOW THESE BASIC STEPS CAN LEAD TO DAMAGE
THAT IS NOT COVERED BY YOUR WARRANTY

1



Read Instructions carefully.
Check no parts are missing.

2

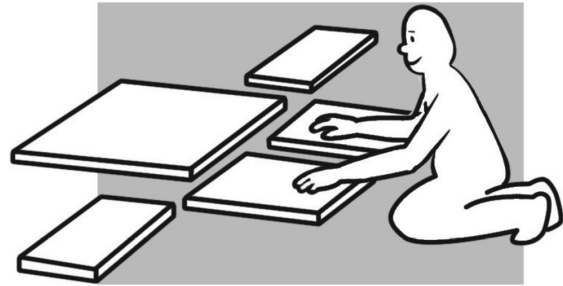

Lay out all of the components on a soft surface
as if you were preparing to do a jigsaw puzzle.

3

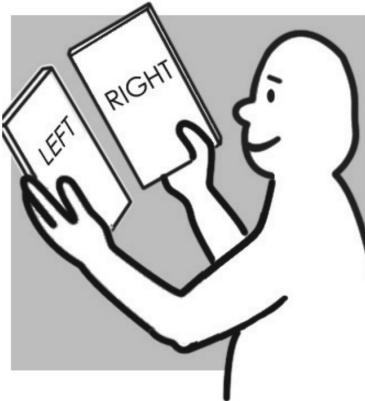

Carefully identify each component, especially
those that are similar. The most common
mistake is getting things back to front.

4



Separate and identify each component from the
hardware pack and rest each one in its proper
location before fastening.

5

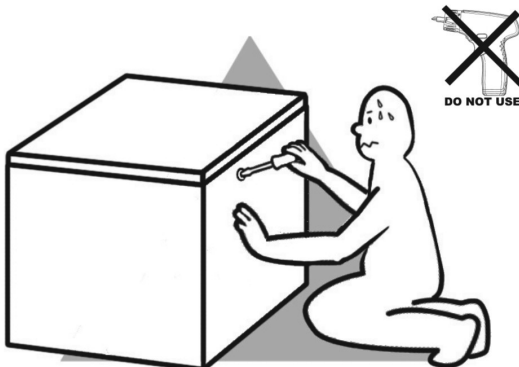

DO NOT fully tighten screws (leave slightly
loose). When the item is fully assembled
tighten the screws - but do not over tighten.

6

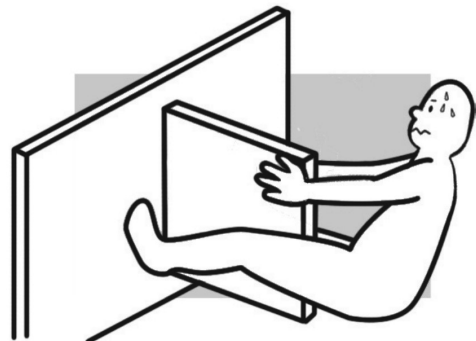

If glue is required **DO NOT** set until you are
certain that the parts belong together.



Safety and Care Advice

Important – Please read these instructions fully before starting assembly

Check you have all the components and tools listed are included.

Remove all fittings from plastic bags and separate them into their groups.

Keep children and animals away from the work area, small parts could choke if swallowed.

Make sure you have enough space to layout the parts before starting.

Do not stand or put weight on the products, this could cause damaged.

Assemble the item as close to its final position (in same room) as possible.

Do not place furniture direct in front of radiators, fires or any other source of heat.



Parts of assembly will be easier with 2 people.

Assemble on soft level surface to avoid damaging the unit or your floor.



We do not recommend the use of power drill/drivers for inserting screws, as this could damage the unit.

Dispose of all packing carefully and responsibly.

General Care And Maintenance

To ensure that you receive maximum pleasure from your new furniture, it is very important for you to care your products.

Maintain the furniture on a regular basis and in accordance with the instructions

Take care to prevent sharp object and avoid contact with chemicals e.g. cosmetics or hair products which may permanently mark the surface,

From time to time check that all the fittings are tight on this piece of furniture.

Always use coasters to protect surface from moisture and heat.

Take care when moving furniture-dragging pieces across the floor will damage the joints.

Avoid exposing your furniture to direct and prolonged periods of sunlight and heat sources as fading and cracking may occur.

Cleaning And Care Of Products

Dust regularly with a clean dry cloth.

Wipe up any spills immediately with a damp cloth and then dry the surface with a clean dry duster.

Remove stubborn stains with weak washing up liquid solution and a damp cloth and dry with a clean duster.

Do NOT use abrasive cleaners.

Do NOT clean with the following or products containing the following:

Acetone (eg nail varnish remover), Ammonia (eg bleach) or Sodium hydroxide (eg Caustic soda, drain and oven cleaners). In the event of accidental contact rinse thoroughly with water

General Information

If for any reason you should have problems with your products, Please retain your receipt as proof of purchase and contact the store from which you purchased it.

A Guide to – Wall Mounting & Fixings

Important Notes:

Important: When drilling into walls always check that there are no hidden wires or pipes etc.

Wall Fixings:



- because of the variety of different wall types, we have provided kind but may not exact fixings you will need to fix this product to the wall.

In this case, you must first identify the type of wall you intend to fix product onto and then contact your local hardware store to get the appropriate fixings.

Make sure that the screws and wall plugs being used are suitable for supporting your unit. Consult a qualified tradesperson if you are unsure.

Hints:

- 1: **General rule:** Always use a larger screw and wall plug if you are not sure.
- 2: Ensure you use the recommended drill bit to match the wall plug and hole size.
- 3: Ensure you drill the hole horizontally, do not force the drill or enlarge the hole.
- 4: Take extra care when drilling high walls, ceilings and ceramic tiles. Ensure wall plugs are inserted beyond the thickness of the ceramic tiles to avoid the tiles splitting or cracking.
- 5: Ensure wall plugs are well fitted and are a tight fit in the drilled hole.

Types of walls

You can use one of the following types of wall plug if your wall are mad of brick, breeze block, concrete, stones or wood.

No.1 'General Purpose' wall plug

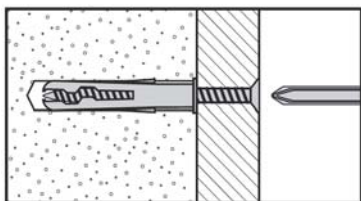

Generally aerated blocks should not be used to support heavy loads, use a specialist fitting in this case. For light loads, general purpose wall plugs can be used.

No.2 'Cavity Fixing' wall plug

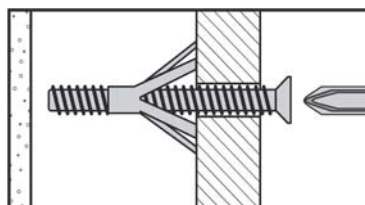

For use with plasterboard partitions or hollow wooden doors.

No.3 'Hammerfixing wall plug

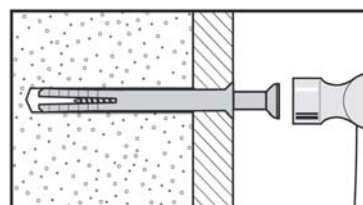

For use with walls stuck with plasterboard. The hammer fixing allows it to be fixed to the wall rather than the plasterboard. Always check the fixing is secure to the

No.4 'Plasterboard' wall plug

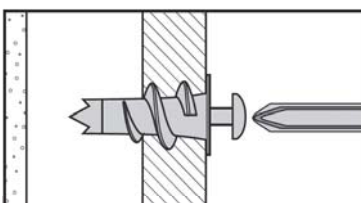

For use when attaching light loads on to plasterboard partitions.

No.5 'Cavity Fixing-Heavy Duty' wall plug

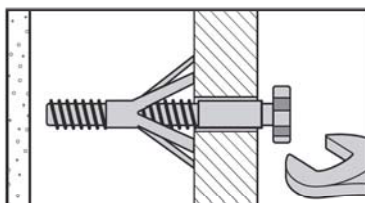

For use when fitting or supporting heavy loads such as shelving, wall cabinets and coat racks.

No.6 'Shield Anchor' wall plug Heavy loads

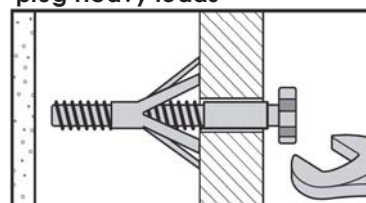

For use with heavier loads such as TV & HiFi speakers and satellite dishes etc.

Ok, let's get rolling

This should be easy, just follow our instructions and you will be back to Netflix in no time.

Estimated time for assembly



60:00

What you need

- Some of your favourite bubbly or your preferred relaxant
- Use the packaging carton as a working surface to prevent product damage during assembly

Weight Limitation



66

lbs for table top

25

lbs per drawer

What's included

Code	Description	Qty
1	Top Panel	1
2	Bottom Panel	1
3	Left Side Panel	1
4	Middle Panel	1
5	Right Side Panel	1
6	Back Panel	1
7	Top Back Stretcher	1
8	Bottom Back Stretcher	1
9	Top Front Stretcher	1
10	Left Side Frame	1
11	Right Side Frame	1
12	Left Drawer Front	1

What’s included cont.

Code	Description	Qty
13	Right Drawer Front	1
14	Drawer Side (Left)	2
15	Drawer Side (Right)	2
16	Left Drawer Bottom Panel	1
17	Right Drawer Bottom Panel	1
18	Right Drawer Bottom Stretcher	1
19	Left Drawer Back Panel	1
20	Right Drawer Back Panel	1

The goods

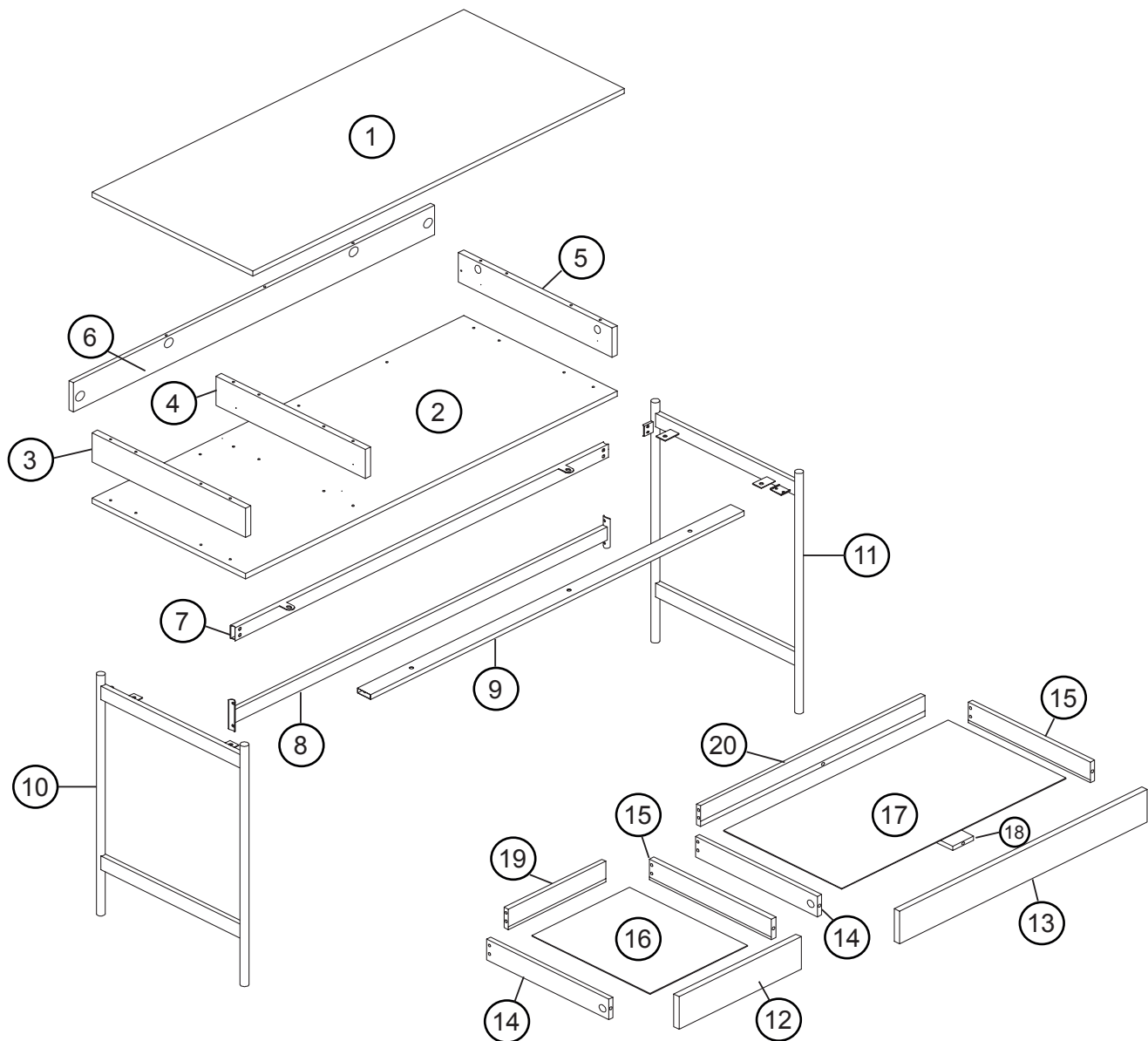

What's included

Code	Description	Qty
A	M6x10MM Bolt	12
B	M6x25MM Bolt	3
C	Handle	2
D	M3x14MM Screw	4
E	Allen Key	1
F	M3.5x12MM Screw	16
G	M6x35MM Cam Bolt	15
H	M15x10MM Cam Lock	15
I	M4x35MM Screw	18
J	M6x30MM Wooden Dowel	14
K	Drawer Slides	2 Sets
L	M6x12MM Bolt	6

The goods

A



B

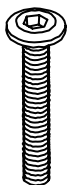

C

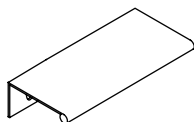

D



E



F



G



H



I



J



K

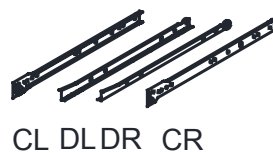

L



IMPORTANT:

1. Do not tighten bolts / screws completely until all bolts / screws are lined up and inserted into holes.
2. Do not over tighten screws and bolts to avoid stripping.
3. Please use hand tools to assemble this product. Do not use power tools.

Step 1

Grab Parts 7, 8, 9, 10 and let's get started with the base of the desk!

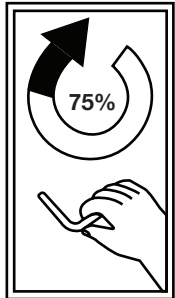

To save you from a future headache, please only tighten the frame 75%. We'll be tightening to 100% on the last step!

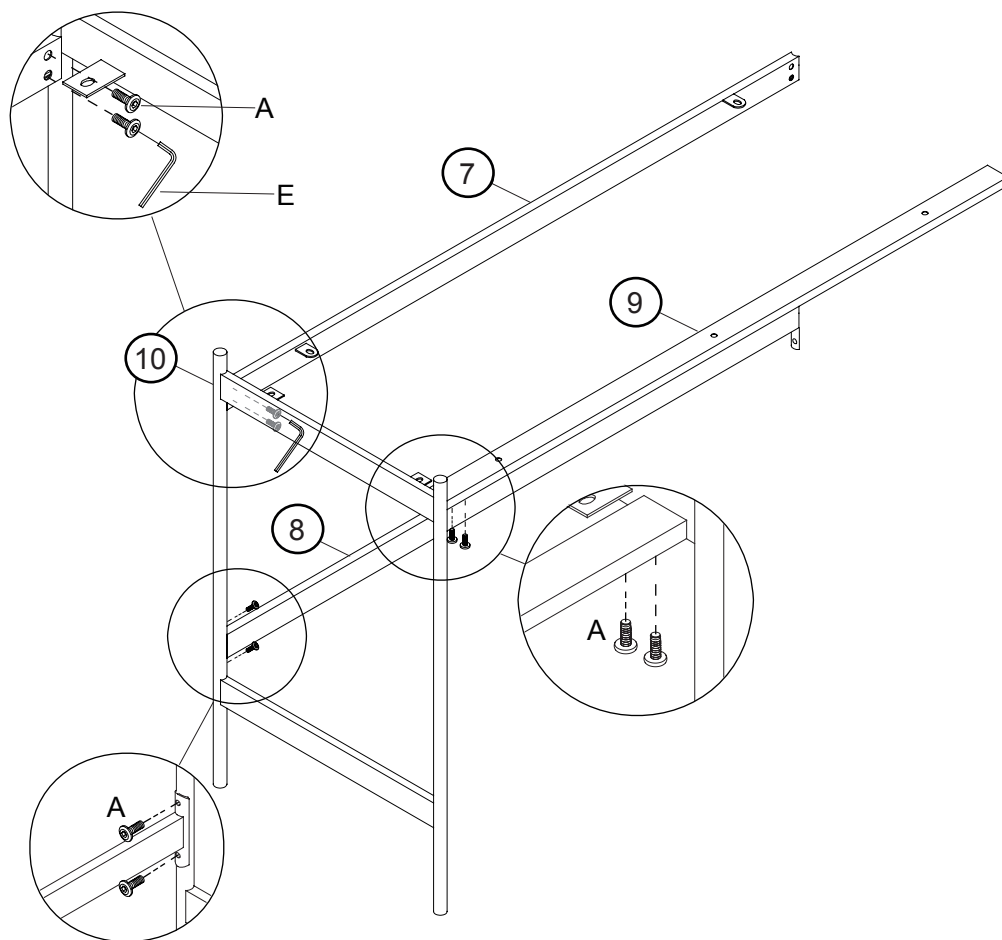

Step 2

Attach the Right Side Frame (11)
to what you completed in Step 1.
You're killin' it.

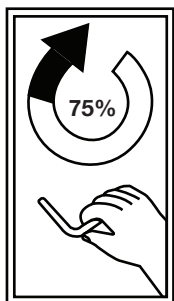

Hey, it's me again, with a
friendly reminder to only
tighten the frame 75%.

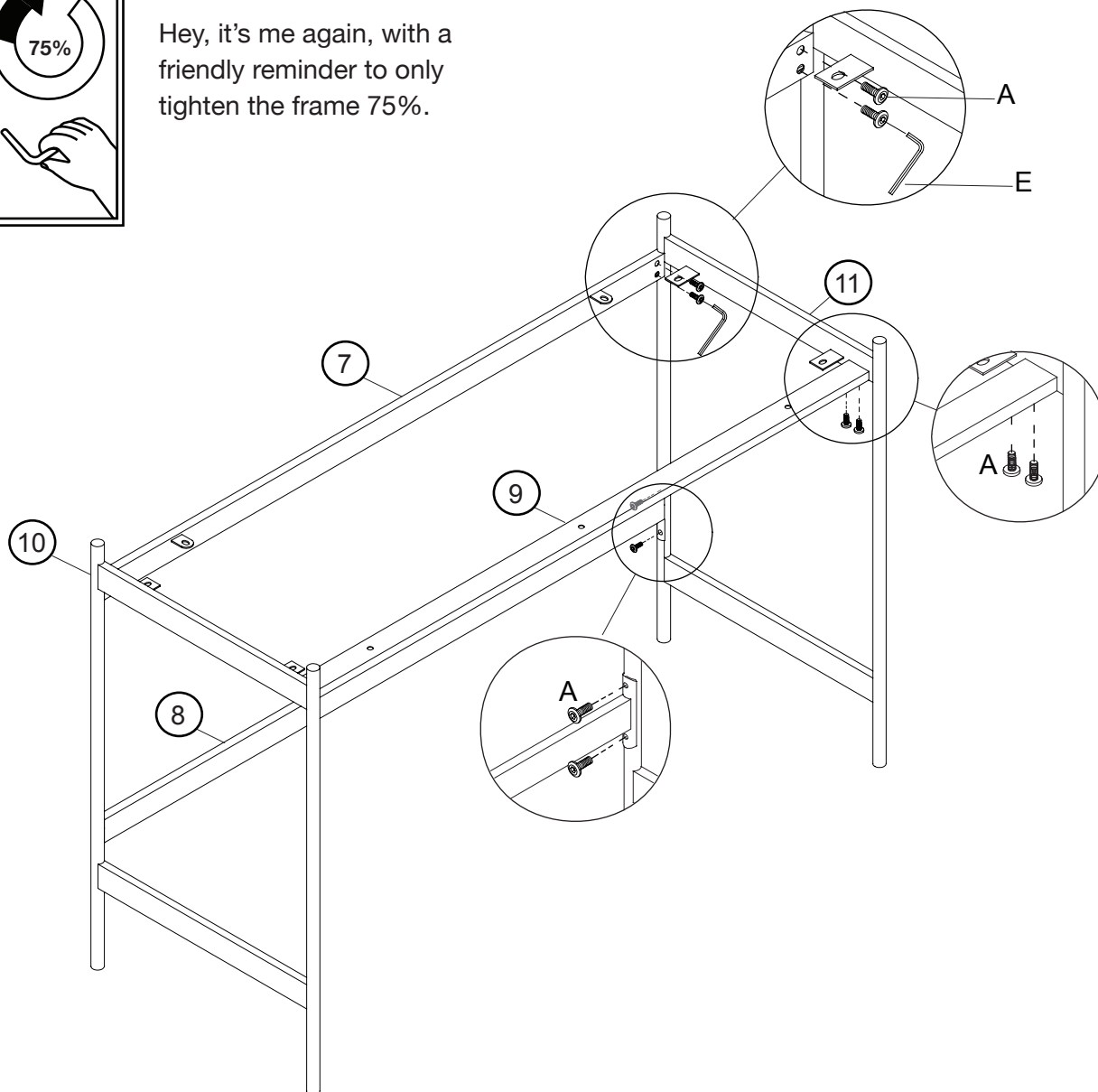

Step 3

Time to assemble the snack drawer! I mean, drawer. Secure Part 19 to Parts 14 and 15.

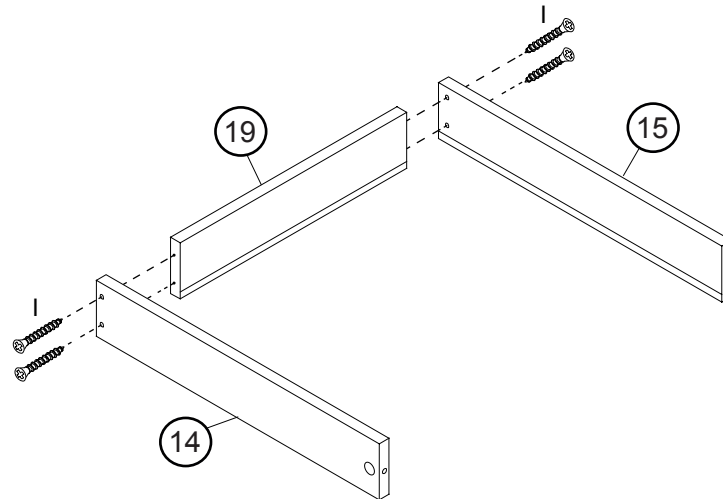

Slide the bottom panel in.

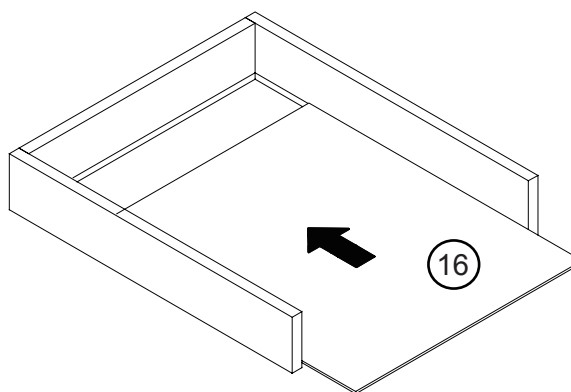

Step 3 cont.

Secure the front of the drawer (12).

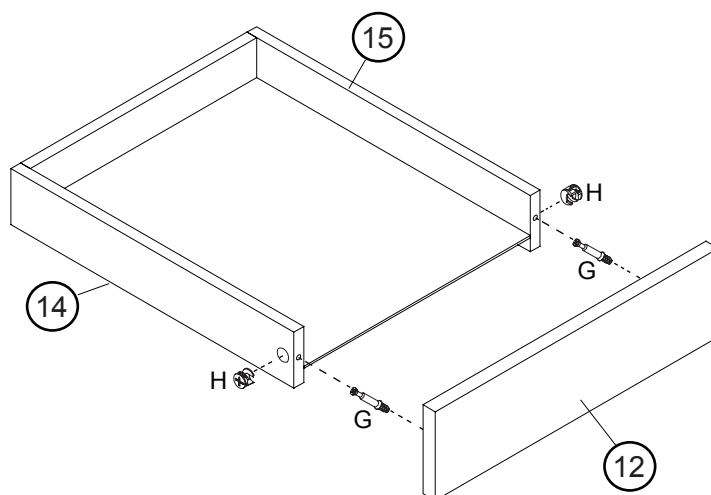

Attach the handle. See, this isn't so bad!

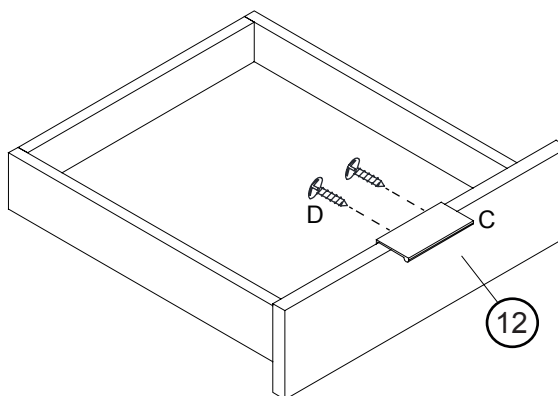

Step 4

Complete the drawer by attaching the drawer slides.

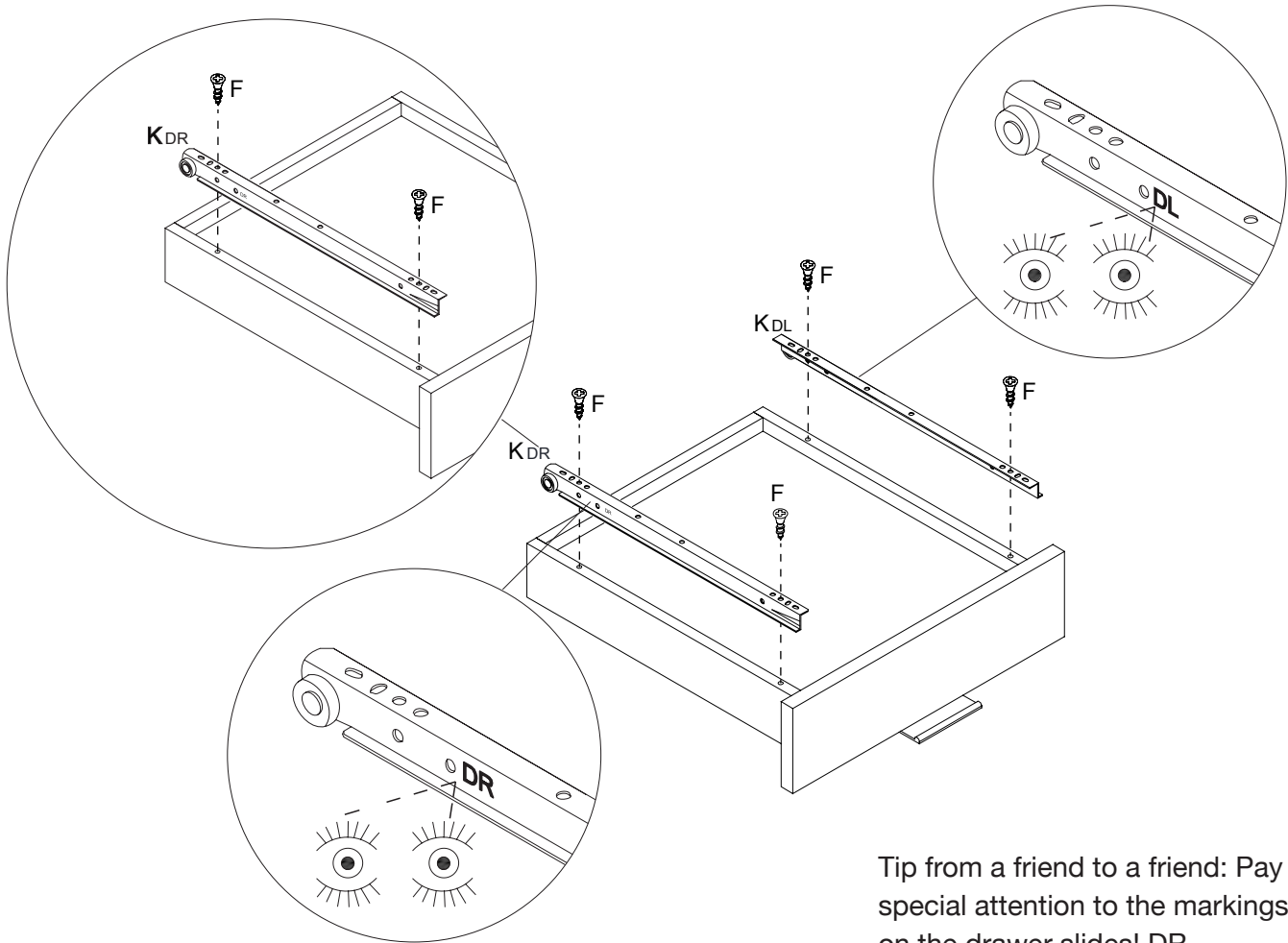

Tip from a friend to a friend: Pay special attention to the markings on the drawer slides! DR represents the right side of the drawer, while DL marks the left side of the drawer.

Step 5

Let's get started on the right drawer. You're basically a professional by now.

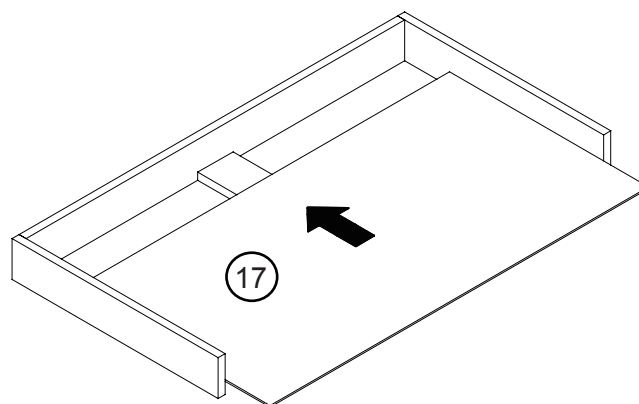
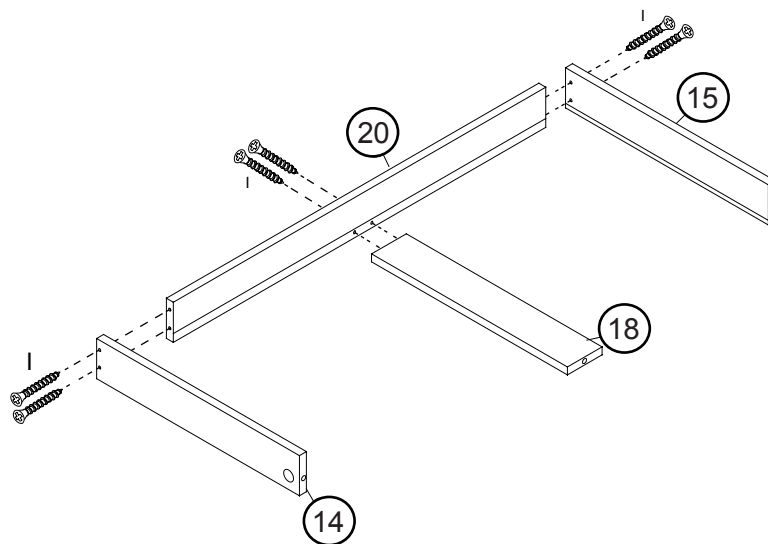

Step 5 cont.

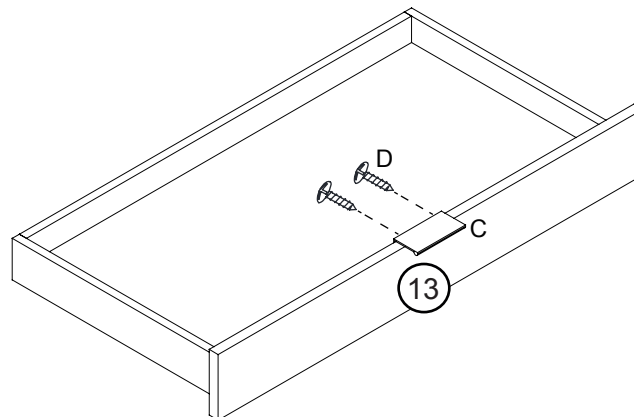
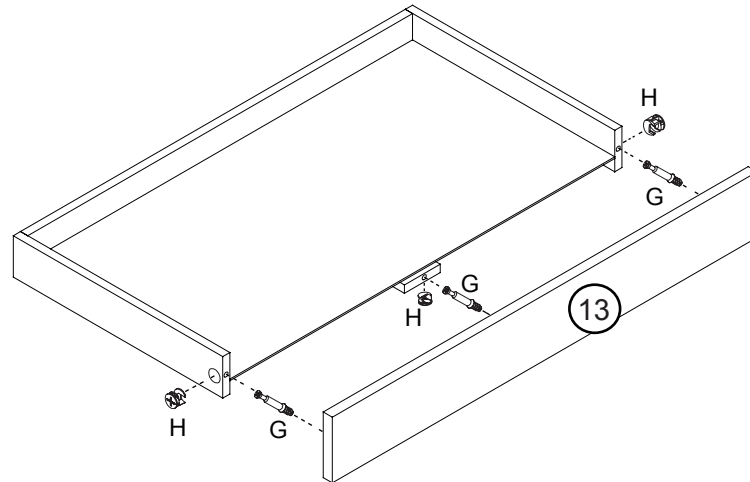

Step 6

No this isn't Deja-Vu! Complete the right drawer by attaching the drawer slides.

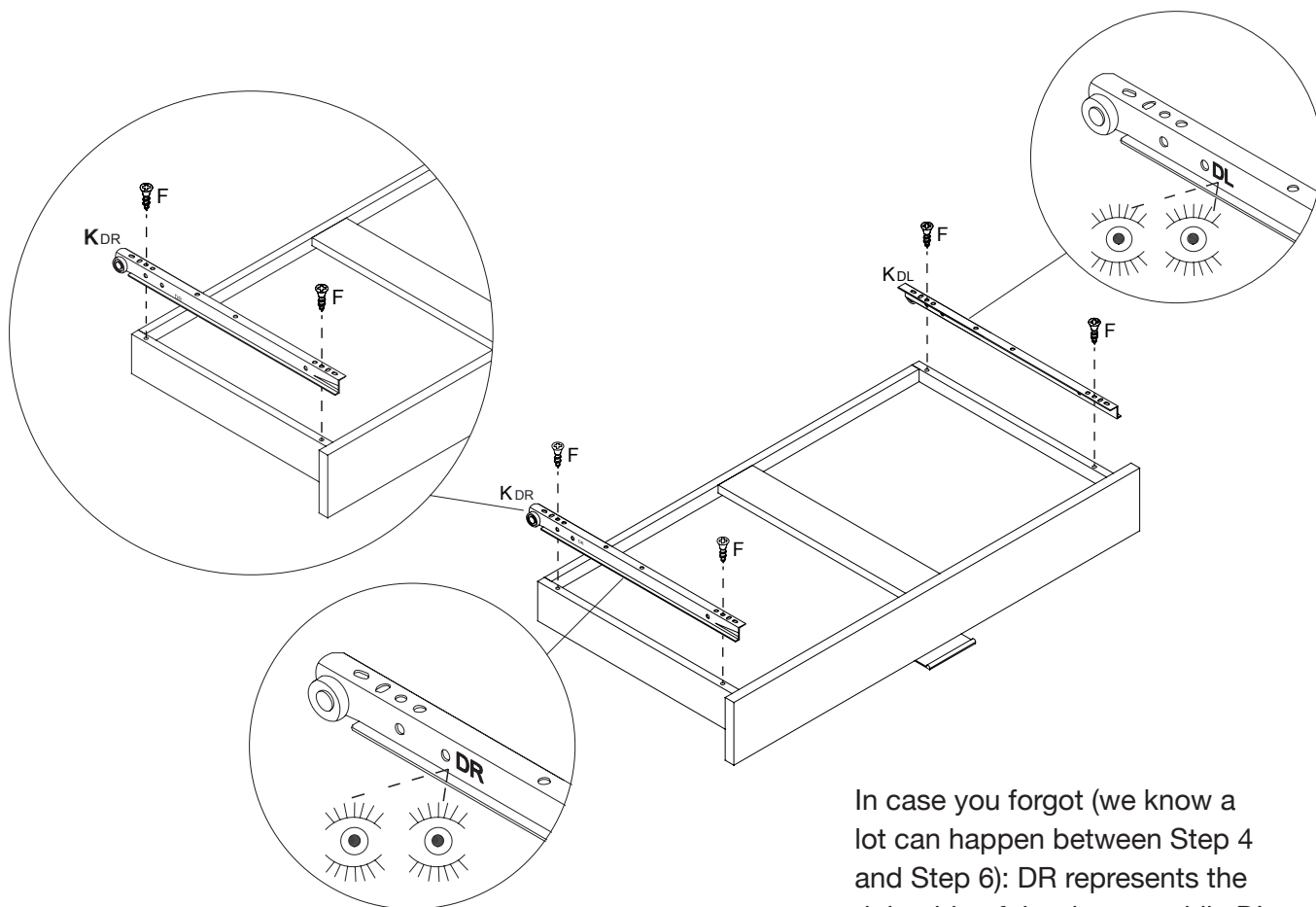

In case you forgot (we know a lot can happen between Step 4 and Step 6): DR represents the right side of the drawer, while DL marks the left side of the drawer.

Step 7

You're doing great. Complete the drawer slides by attaching them to the Left, Middle, and Right Side Panels.

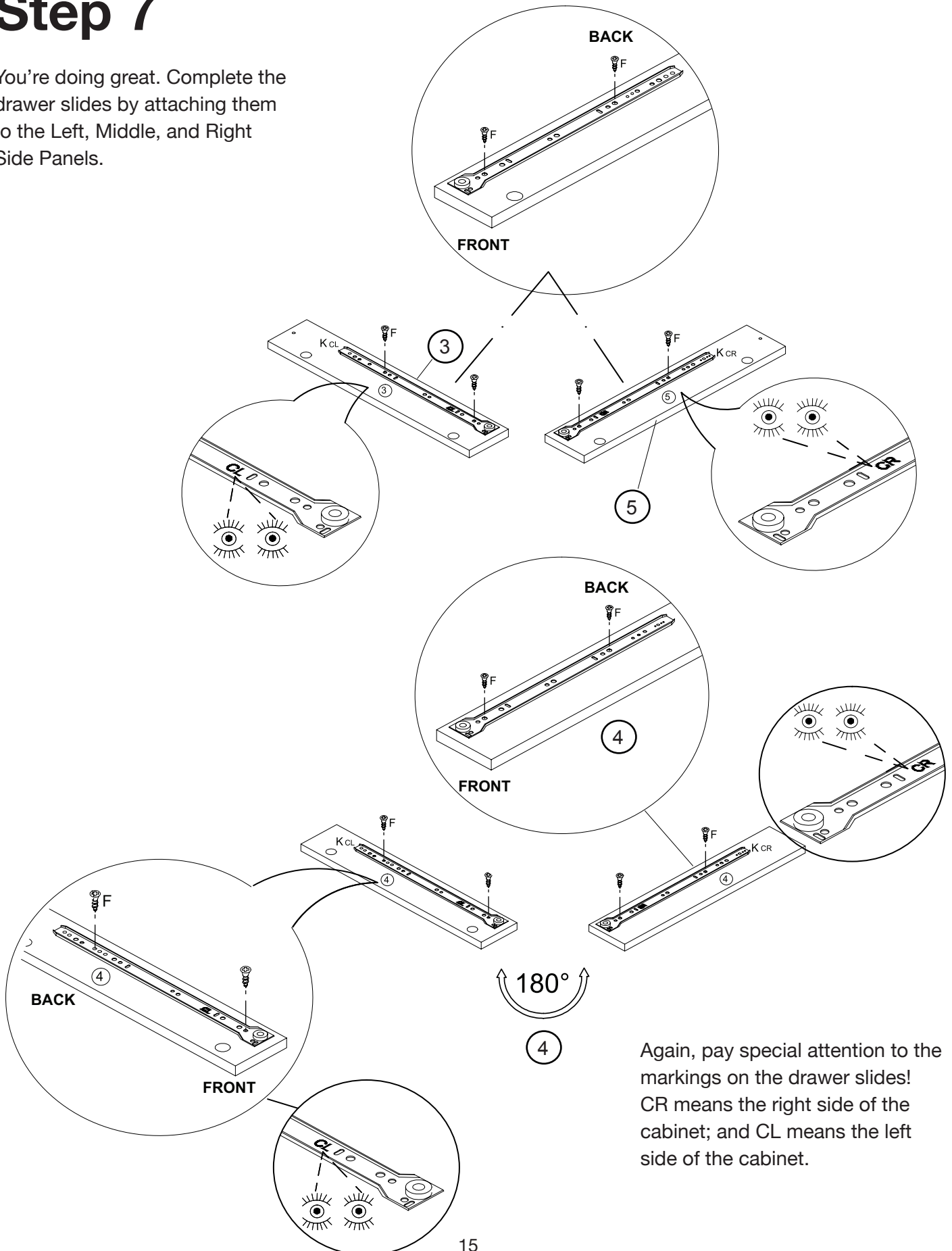

Again, pay special attention to the markings on the drawer slides! CR means the right side of the cabinet; and CL means the left side of the cabinet.

Step 8

Believe it or not, only three more steps after this one. Take the Left Side Panel (3) and Right Side Panel (5) and secure it to the Back Panel (6).

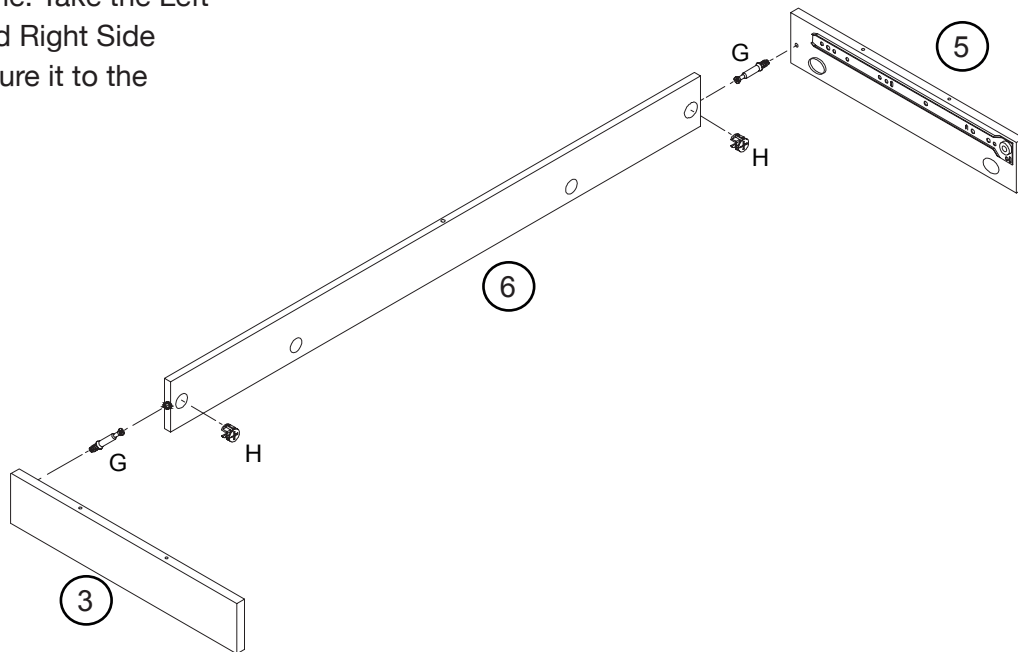

Insert Wooden Dowels (J) into Parts (3), (4), (5), and (6).

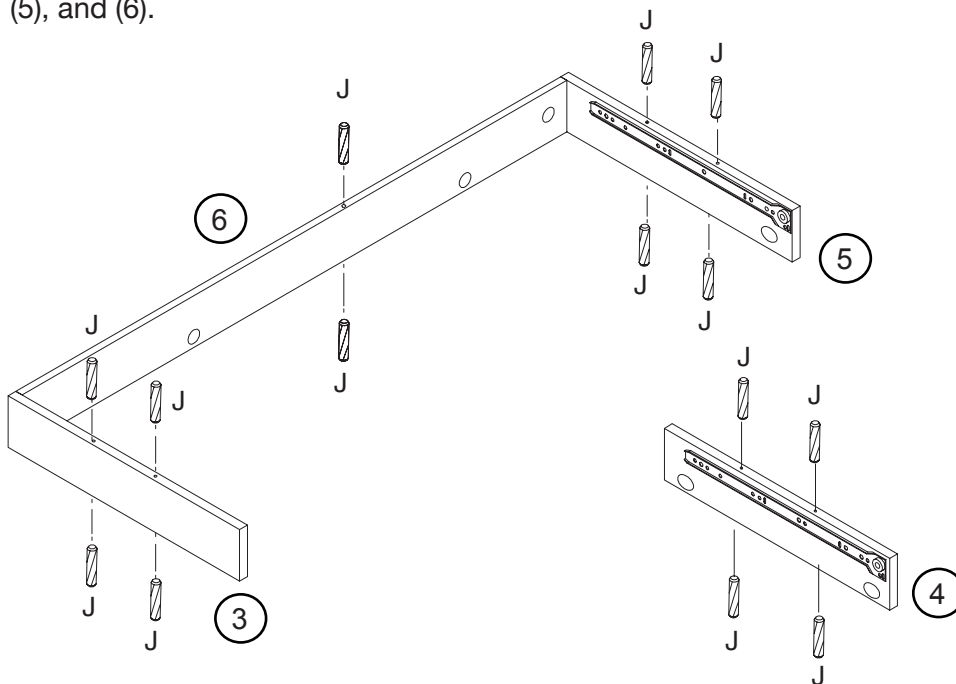

Step 9

How much wood would a woodchuck chuck?

I apologize...Where were we?

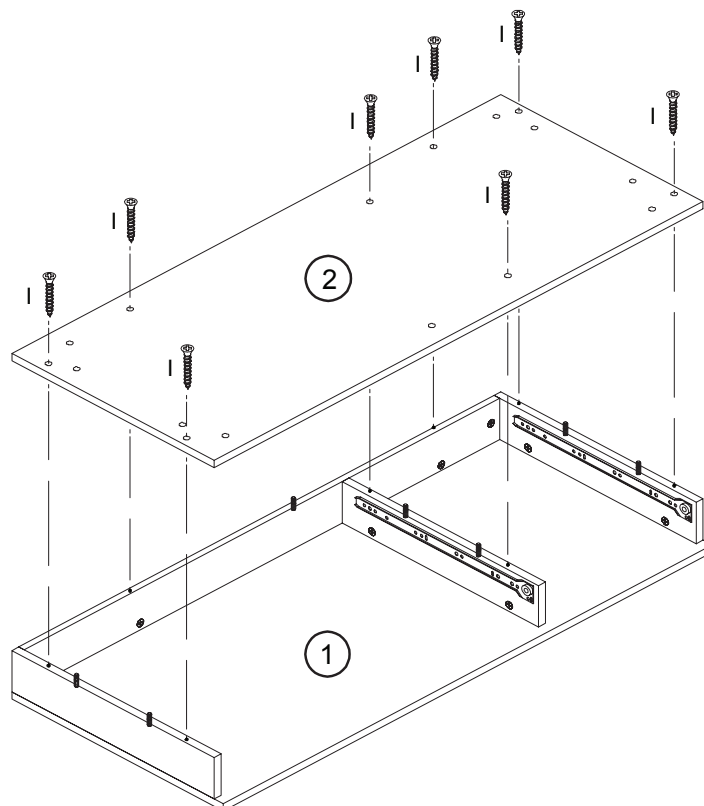
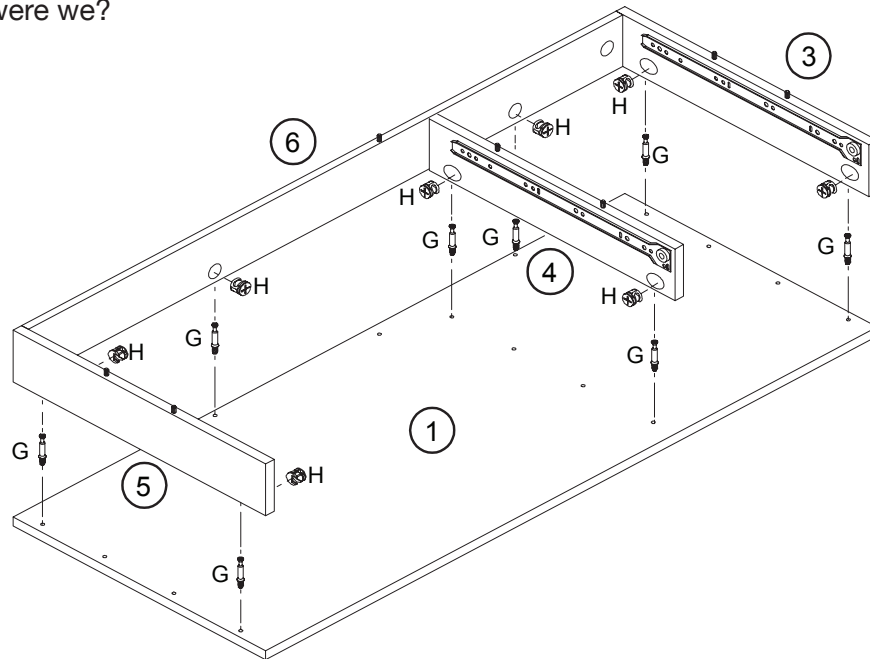

Step 10

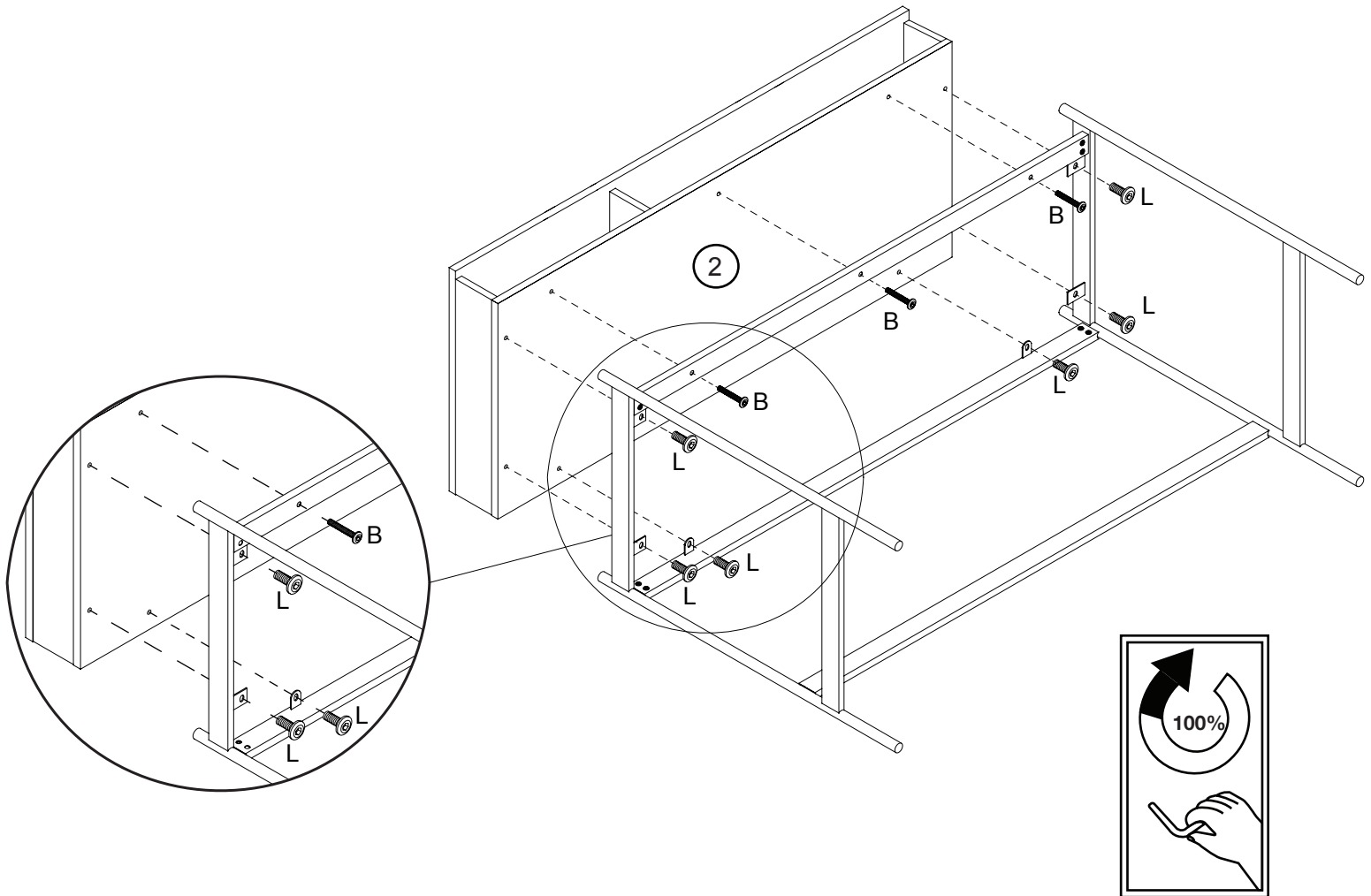

The moment we've all been waiting for... Once all the connections between the metal frame and table top are lined up, tighten everything to 100%.

Step 11

Insert the drawers and adjust the footpads to level the desk.

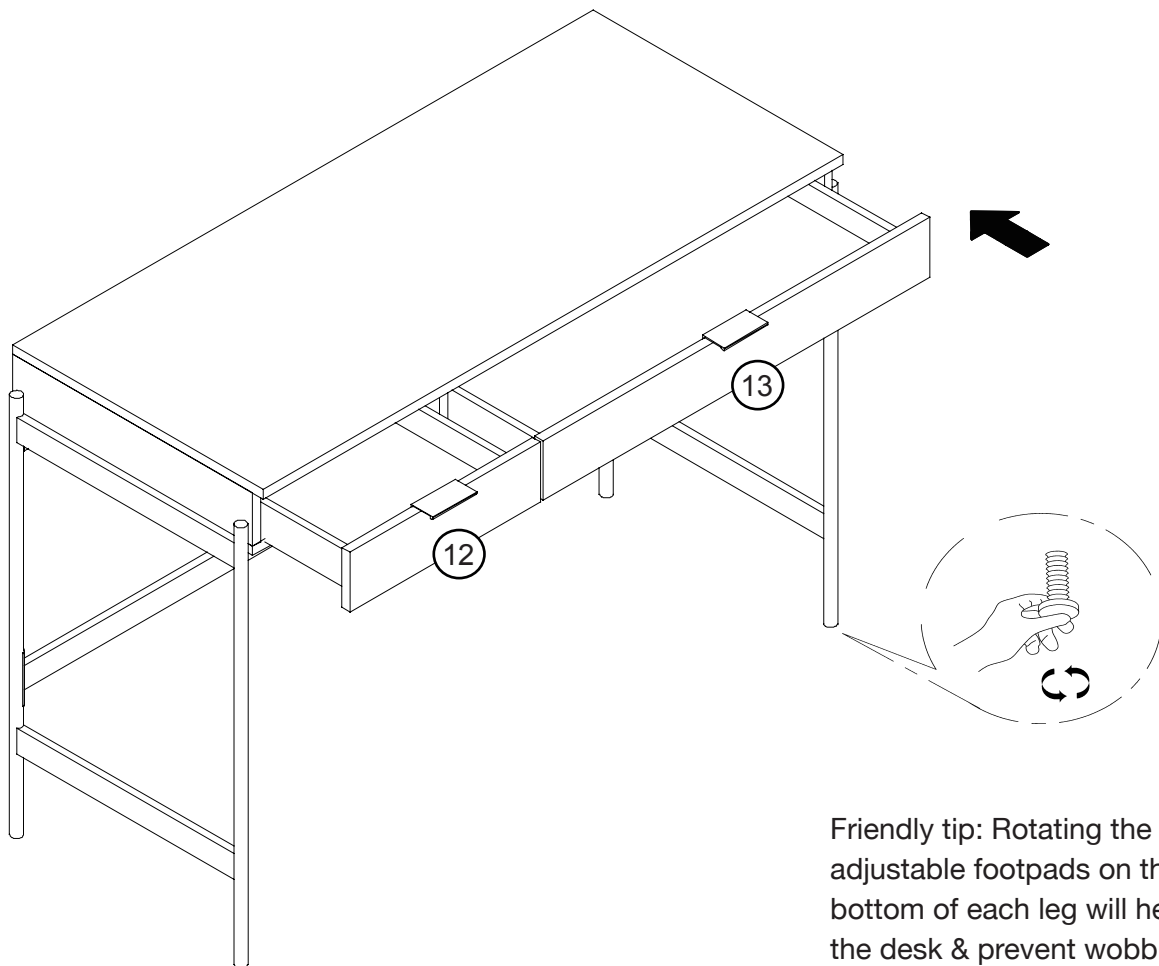

Friendly tip: Rotating the adjustable footpads on the bottom of each leg will help level the desk & prevent wobbling.

Ta-da! Chip and Joanna
Gaines would be so proud.